



CORPORATE SUMMARY



“ Westports expansions would pave the way for significant further growth in the coming decades as we serve our customers, international container shipping alliances and local logistics stakeholders. ”

- Datuk Ruben Emir Gnanalingam Bin Abdullah,
Group Managing Director

“ Today, with Westports, I have proved that ports do not have to be dirty and can be beautiful. I have also demonstrated that port operations are a profitable business, so much so that everyone now wants to own a port. ”

- Tan Sri Datuk Gnanalingam,
Executive Chairman



WESTPORTS

PROVEN. TRUSTED. FRIENDLY.

NO. 1 SEAPORT IN MALAYSIA

SECOND BUSIEST PORT IN SOUTH EAST ASIA

TOP 5 CONTAINER VOLUME HANDLED OUTSIDE CHINA

12TH BUSIEST PORT GLOBALLY BASED ON CONTAINERS HANDLED

CONNECTIONS TO MORE THAN 350 PORTS GLOBALLY

801 MOVES (NEW WORLD RECORD) WITHIN 1 HOUR

NATURAL DEEP HARBOUR UP TO 18 METER

HIGH PRODUCTIVITY OF 35 MOVES PER HOUR CONSISTENTLY

CAPACITY TO HANDLE 23,000 TEUS VESSEL-SIZE

EQUIPPED WITH 67 WORLD LARGEST SHIP-TO-SHORE CRANES



WESTPORTS
PROVEN. TRUSTED. FRIENDLY.



WESTPORTS WHERE IT ALL



1994-1995

"The Green Field"- from swamp area to a port.
Westports under construction.

S MALAYSIA ALL STARTED



1996 Westports, Malaysia's newest and most advanced port, was officially opened by former Prime Minister Dato Seri Dr. Mahathir Mohamad.

TIMELINES



WESTPORTS WORLD RECORDS



Setting a new world record of 734mph on CSCL Pusan, a 9,600 TEUs vessel.

Maiden call of world's largest vessel CSCL Venus China which was welcomed by Deputy Minister of Finance Dato Donald Lim, vessel capacity of 14,100 TEUs.



Celebration of 20th Anniversary that was officiated by Tun M. VISION 2020 AHEAD OF SCHEDULE. Achieving target set by Tun M in 1994, 6 years earlier (2014)



Celebrating Westports silver jubilee, 25 Years Anniversary.



The only Malaysian port to achieve 10mil TEUs. Achieved record high of 10.9 mil TEUs in 365 days in 2019.



Achieving a new world record of 801 mph on CMA CGM Jean Mermoz in 2019.

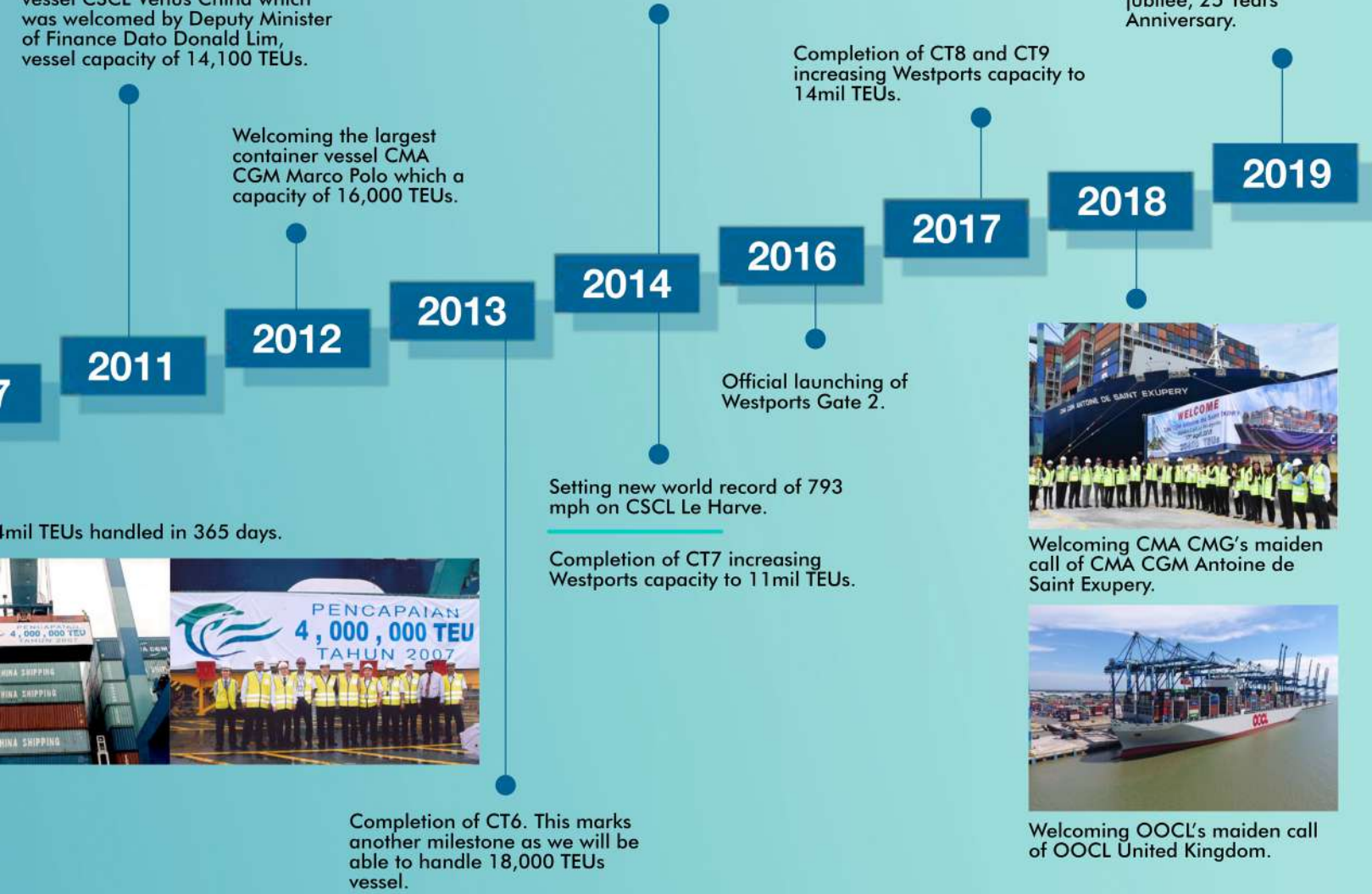

WESTPORTS CONTAINER VOLUME

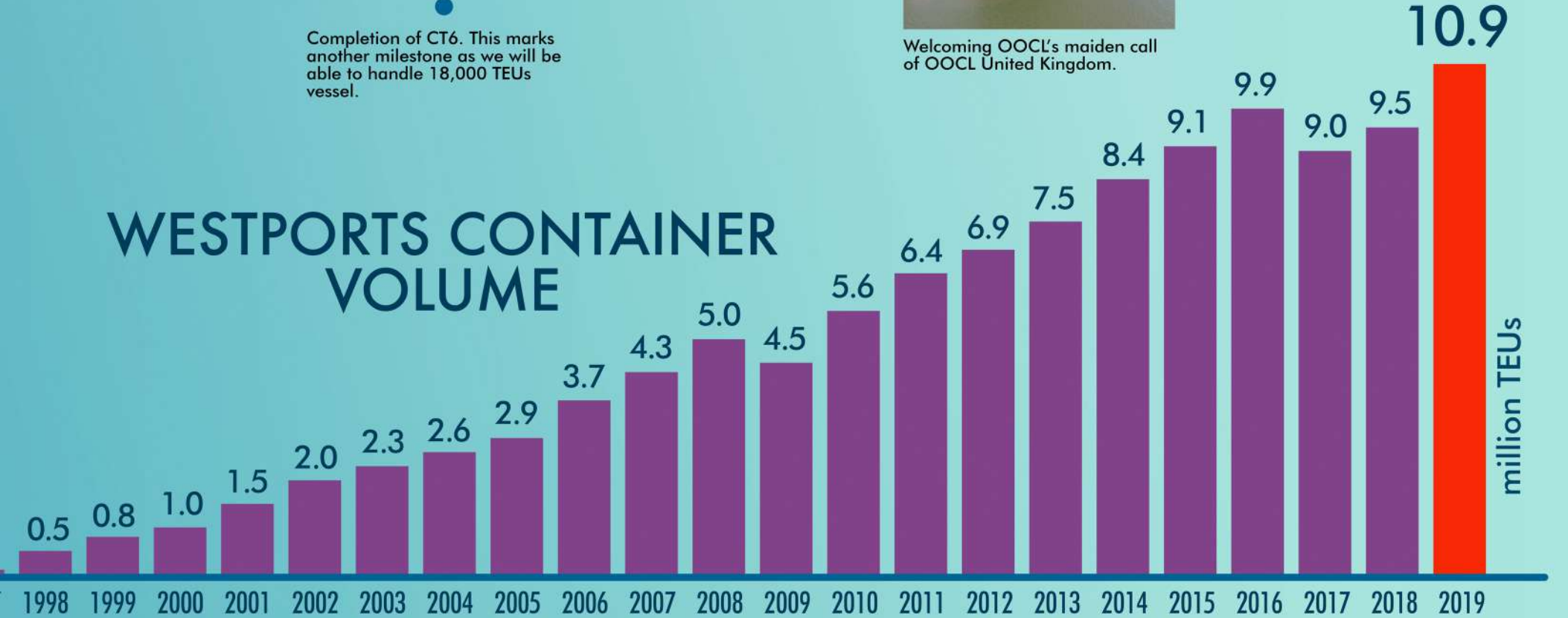

Our container business has grown exponentially from 20,000 TEUs in 1996 to 10.9 million TEUs in 2019. Our market share of container business represents 80% in Port Klang in 2019.

- 01 NO 1 SEAPORT IN MALAYSIA
- 02 SECOND BUSIEST PORT IN SOUTH EAST ASIA
- 03 TOP 5 CONTAINER VOLUME HANDLED OUTSIDE CHINA
- 04 12TH BUSIEST PORT GLOBALLY BASED ON CONTAINERS HANDLED
- 05 CONNECTIONS TO MORE THAN 350 PORTS GLOBALLY
- 06 801 MOVES (NEW WORLD RECORD) WITHIN 1 HOUR
- 07 NATURAL DEEP HARBOUR UP TO 18 METER
- 08 HIGH PRODUCTIVITY OF 35 MOVES PER HOUR CONSISTENTLY
- 09 CAPACITY TO HANDLE 23,000 TEUS VESSEL-SIZE
- 10 EQUIPPED WITH 67 WORLD LARGEST SHIP-TO-SHORE CRANES

Container Terminal

- Capacity: 14.0 mil TEUs
- 67 Twin Lifts
- 185 RTGs
- Berth Length: 5,800 Meters, 20 Berths
- Berth Depth: 15m – 17.5m
- Capable of handling vessels of all sizes

Welcoming Bigger Container Vessels

Water depth of 17.5 meters to accommodate the world's largest vessels today

1996	2,900 TEUs
1999	6,600 TEUs
2006	8,400 TEUs
2011	14,100 TEUs
2012	16,100 TEUs
2014	19,100 TEUs
2018	21,413 TEUs

Westports Proximity:



SKVE Highway

Distance
14KM

Average time
15 mins

Kesas Highway

Distance
18.6KM

Average time
19 mins



**Shah Alam
(Capital of Selangor)**

Distance
36.7KM

Average time
34 mins



Kuala Lumpur

Distance
60.6KM

Average time
1 hr



**KLIA
(International Airport)**

Distance
74.1KM

Average time
55 mins

ONE-STOP BUSINESS CENTRE IN WESTPORTS

- Government Agencies, ATMs and Shipping Lines
- Integrated Westports' Smart Card Security System (SCSS) for enhanced security
- Westports Documentation Center (WDC) that operates 24 hours
- Call Center



**Royal Malaysian
Customs Department**



**Standard and
Industrial
Research Institute
of Malaysia
(SIRIM)**



**Immigration
Department**



**Malaysian
Quarantine and
Inspection Services
(MAQIS)**



**Ministry of
Health Malaysia**



OUR VALUE ADDED SERVICES



- ▶ On-Dock Depots
- ▶ Warehousing
- ▶ Console Centre
- ▶ Inspection Bay
- ▶ Fumigation
- ▶ Drayage
- ▶ Inter-Terminal Transfer
- ▶ Rail Freight Station
- ▶ Dangerous Goods covered storage
- ▶ Storage Services
- ▶ Reefer Services
- ▶ Container Freight Stations

PORT LAYOUT

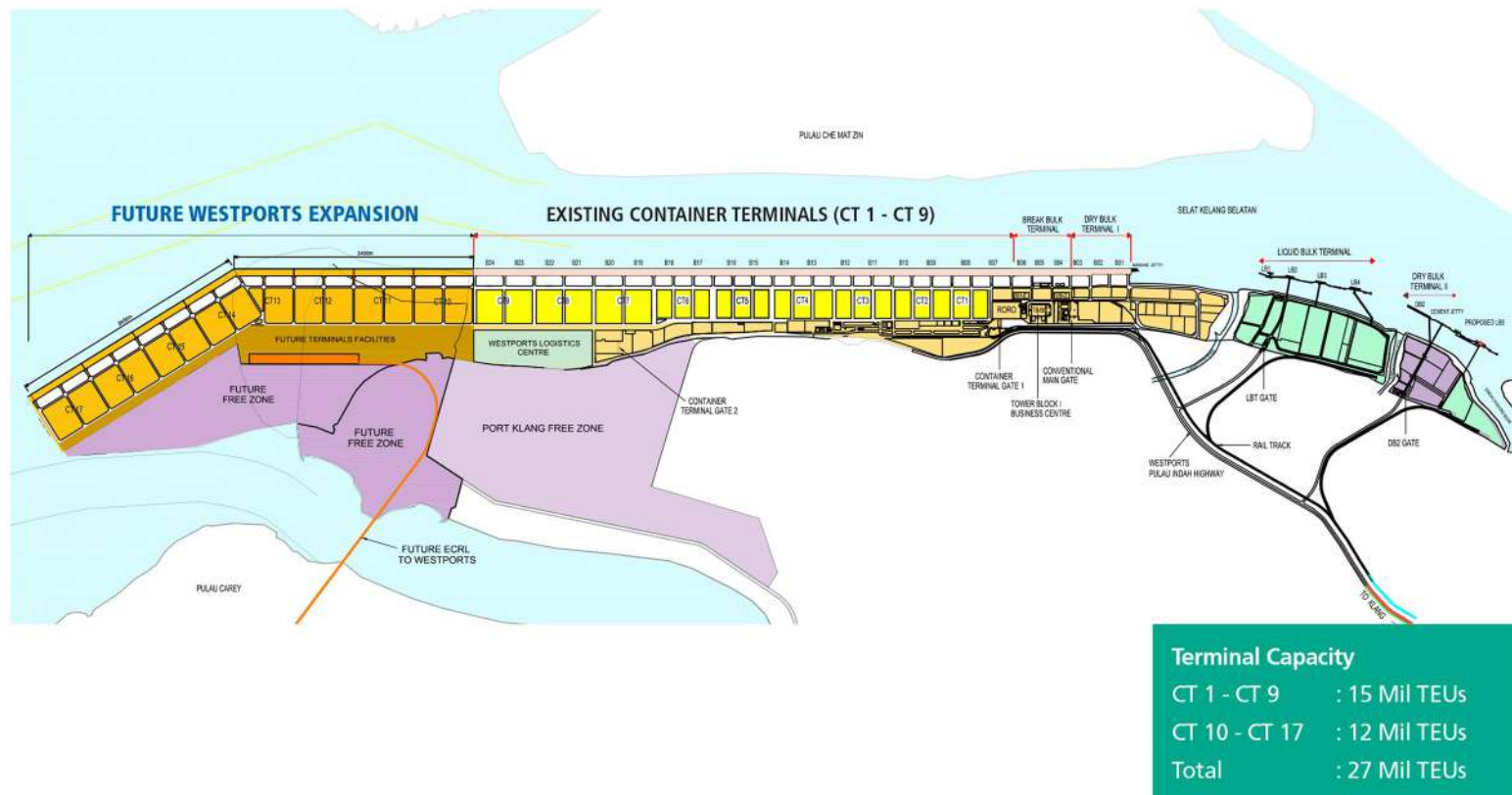

OUR NEIGHBOURS

Pulau Indah Industrial Park

- Develops industrial & commercial park on Pulau Indah.
- Home to multiple MNCs that utilizes Westports as a global gateway.
- Well connected by 2 main highways and world-class infrastructure.



Port Klang Free Zone

- An integrated 1,000-acre Free Commercial and Industrial Zone.
- International cargo distribution and consolidation centre.
- Direct access into Westports to over 350 ports worldwide.
- Regional distribution centre for London Metal Exchange, Polymer Resins, Cotton, as well as the National Halal Park.



CONVENTIONAL TERMINALS

LIQUID BULK



- Berth length: 1,307 meters
- 90 different types of cargo
- Bunkering facilities with discharge rate of up to 3,000 tonnes/hour

ROLL-ON ROLL-OFF



- Five available berths designed to accommodate vessels that carry wheeled cargo
- Caters for import/export vehicles such as cars, trucks and excavators
- Total of five main open yards situated on approximately 17.2 hectares of land

BREAK BULK



- Aggregate total berth length: 400 meters
- Handles iron, steel products, coils, machinery, linerboard, wood pulp

DRY BULK AND CEMENT



- Dry Bulk Terminal 1: Two berths
- Dry Bulk Terminal 2: One berth
- Aggregate berth length: 650 meters
- 10,000-meter conveyor belt for intra-port transportation with discharge rate of up to 2,000 tonnes/ hour
- Cement: One Berth
- Berth length: 285 meters

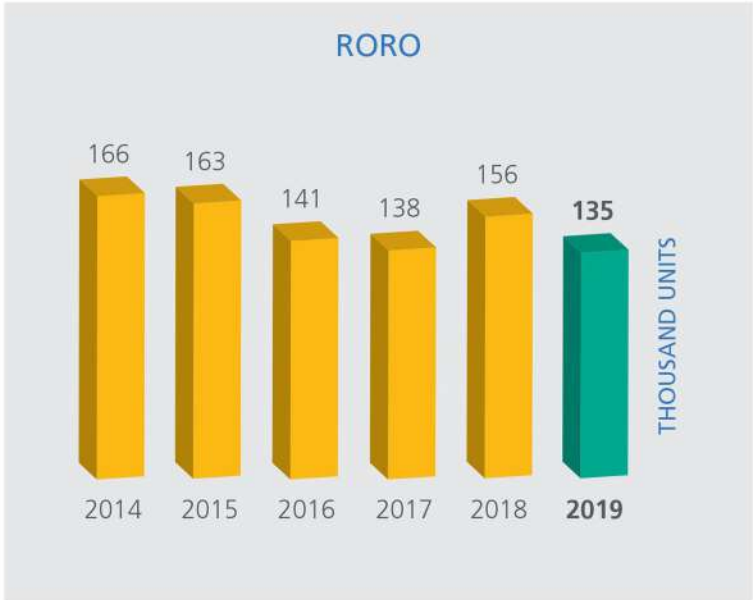
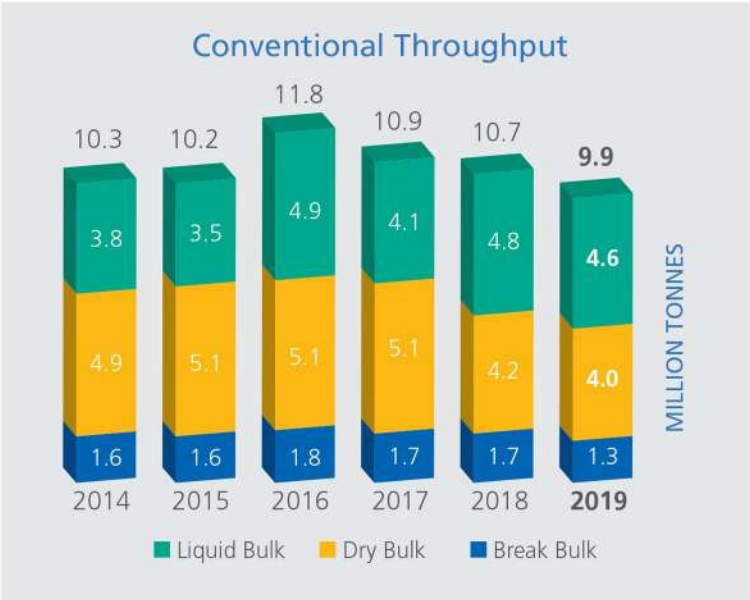

- > Widening of the entrance of existing navigation channel up to 800m with a dredged depth of -18m
- > Navigation width of the existing south channel will be maintained at 500m
- > 8 containers terminals CT10 to CT17

- > Quay length of 600m per terminal
- > Total of 16 berths
- > 8 additional terminals & container yard facilities



WESTPORTS EXPANSION

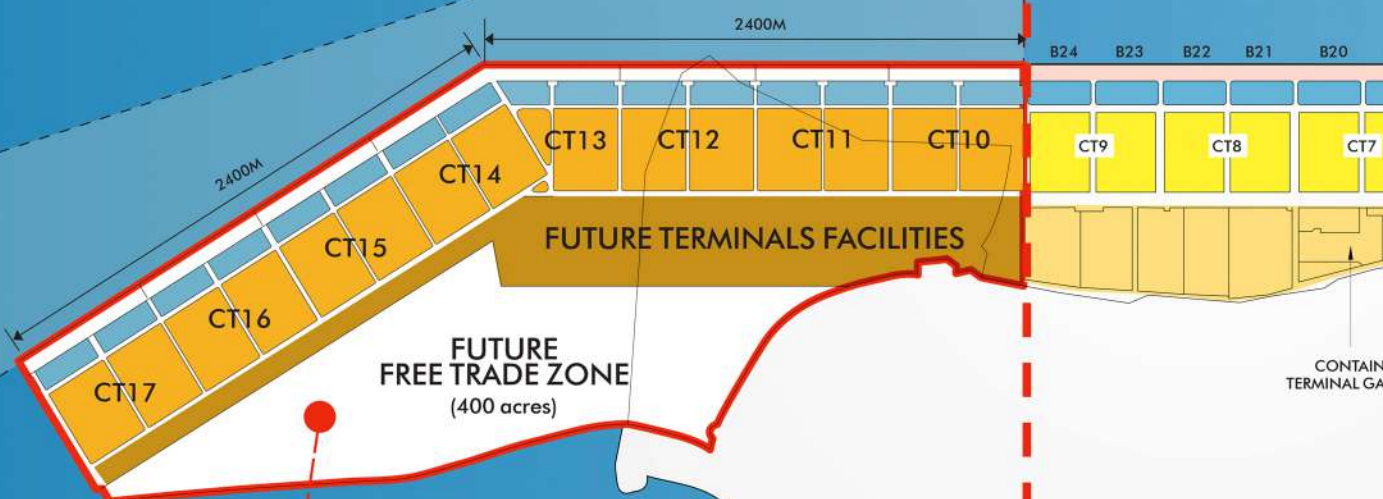

These expansions would pave the way for significant further growth in the coming decades as we serve our customers, international container shipping alliances and local logistics stakeholders.



RE
P-C

In-house
to autom
checkin

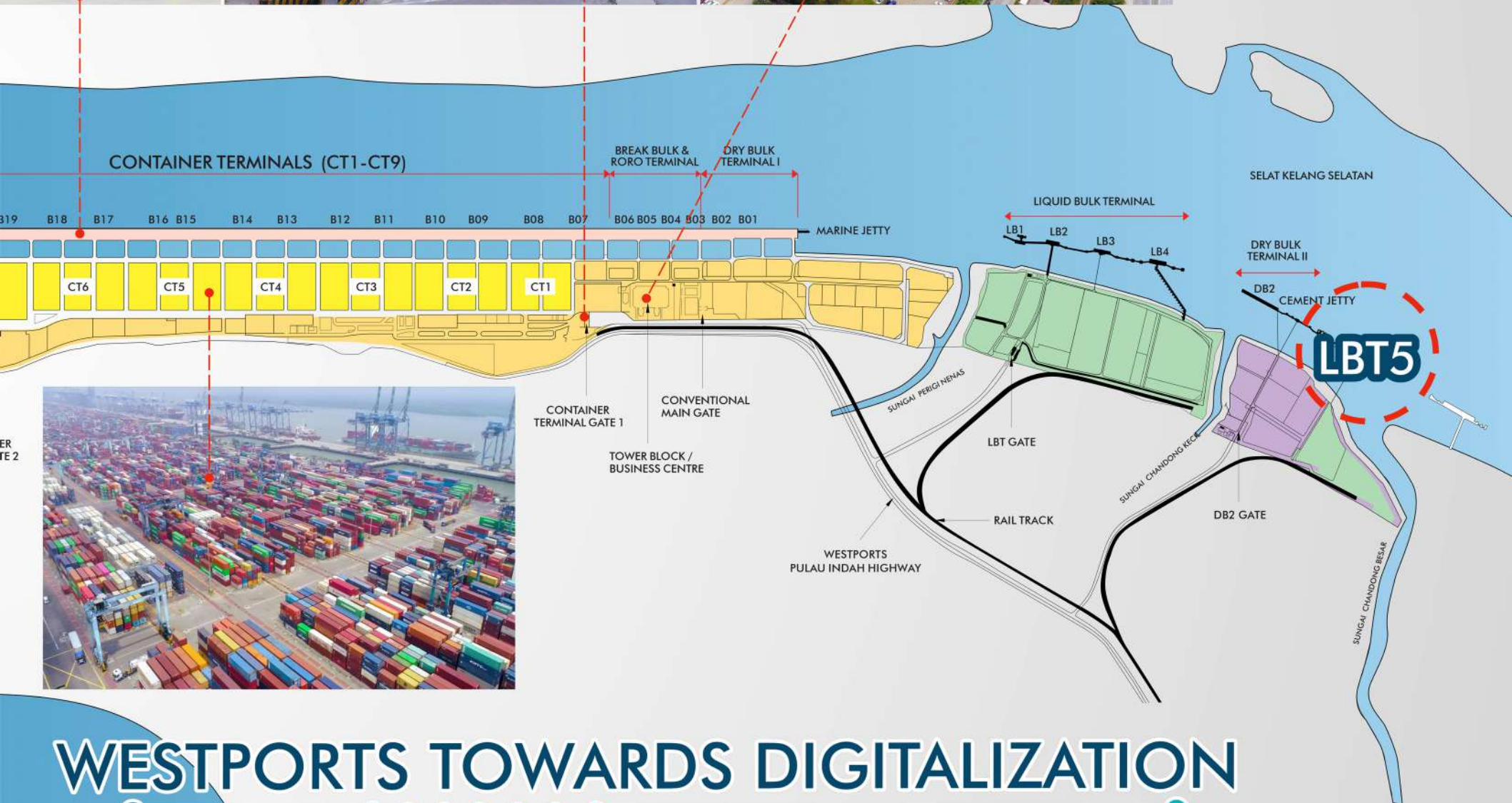

WESTPORTS TOWARDS DIGITALIZATION

MOTE CHECK

enhancement
ated container
g processes

GPS SYSTEM

In-house developed
system to identify the
positions of terminal
equipment

ERP SYSTEM

Enhancing current ERP
system for further
improvement in Finance
& HR processes

e-TERMINAL PLUS

Connecting various port
communities, providing
greater operational
efficiencies & cost saving

TERMINAL OPERATION SYSTEM (TOS)

Invested in a new
Terminal Operating
System to ensure a more
productive and efficient
port operations.

Digitalizing the entire port from Gate Operations, Vessel Operations and Yard Operations.

WESTPORTS GLOBAL CONNECTIVITY

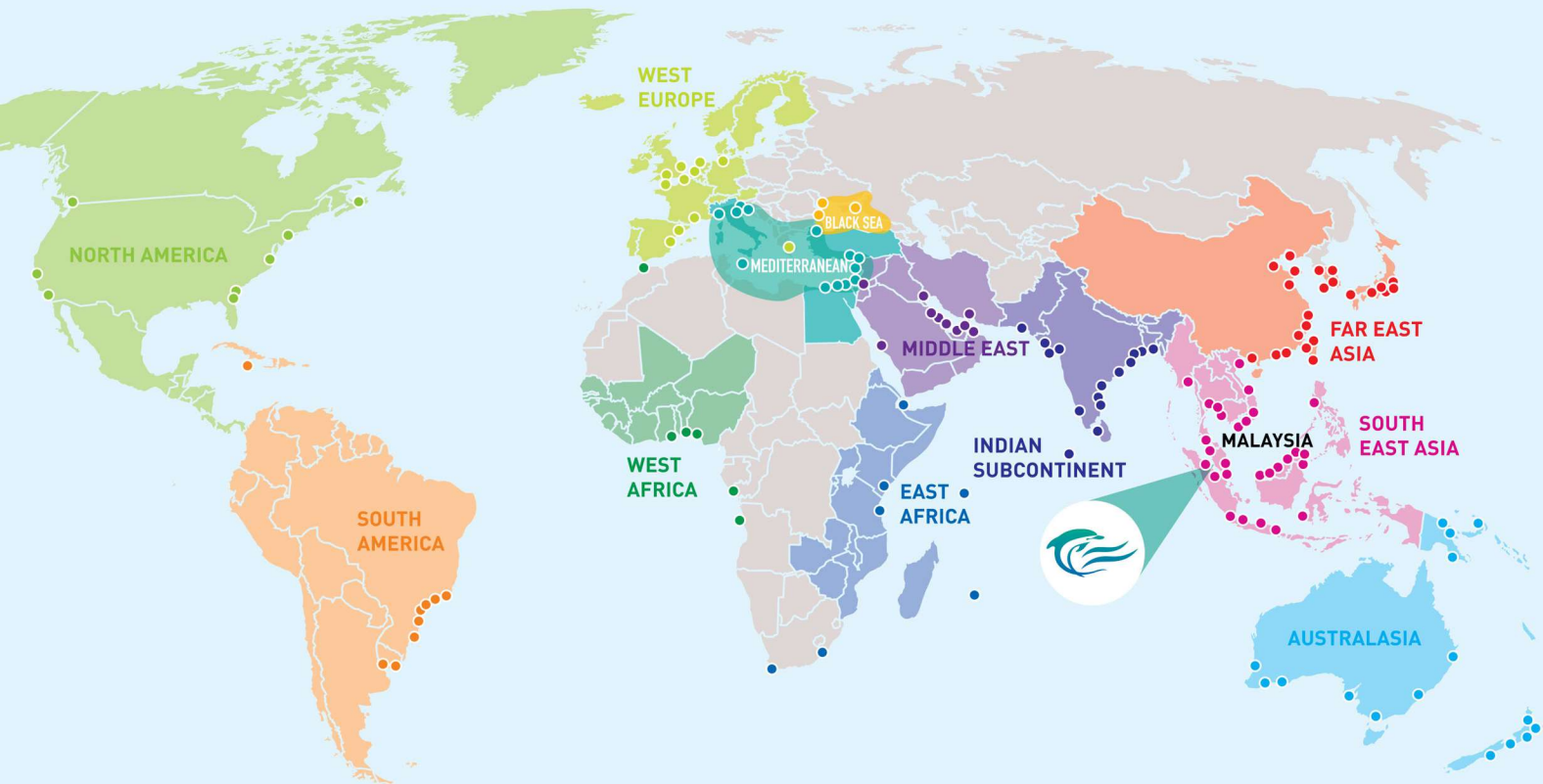

**CONNECTIVITY TO MORE
THAN 350 PORTS WORLDWIDE**

WESTPORTS MALAYSIA SDN BHD (192725-V)

P.O. Box 266, Pulau Indah, 42009 Port Klang, Selangor Darul Ehsan, Malaysia.

Tel: 603-3169 4000 **Fax:** 603-3169 4119

www.westportsmalaysia.com

 www.facebook.com/westportsmalaysia

 twitter.com/westports

 www.linkedin.com/company/westports-malaysia